

8

34 ANGLE PROJECTION

DRAWING No. C

**WHEN ORDERING REPLACEMENT PARTS**

eg. NO. 2, BRAKE NUT  
9192 - 1243

NO. 5,	9193
NO. 2,	9192
WINCH	PRODUCT CODE

33 EXTENSION COUPLING	1	4209
32 PINION HIGH RATIO	1	2013
OPTIONAL EXTRAS NOT SHOWN		

31 GREASE NIPPLE 90°	1	535-041
30 GREASE NIPPLE STR.	3	535-029
29 NUT INCLUDES R.	1	165-273
28 PIN	2	3307
27 WASHER	3	860-417
26 NUT SAE	6	540-410
25 BOLT	1	165-731
24 SPACER	1	6517
23 SPLIT PIN	1	576-014
22 PALM DOUBLE ACTING	1	4108
21 HANDLE GRIP	1	452
20 HANDLE PIN	1	453
19 HANDLE BAR	1	2638
18 SPRING PALM	1	705
16 NUT "CASTLE"	1	540-640
15 SPRING PLUNGER	2	703
14 PLUNGER CAP	2	6202
13 PLUNGER	2	112
12 BOLT INCLUDES 29	1	165-273
11 NUT "NYLOC"	1	540-660
10 RELEASE WASHER	1	623
9 TIE BAR	3	2613
8 BRAKE NUT	1	1243
7 RATCHET	1	2526
6 FIBRE BRAKE DISC	2	7804
5 PINION	1	2016
4 GEAR	1	5102
3 WINDING DRUM	1	5101
2 END FRAME	1	5002
1 END FRAME	1	5004
NO.	TITLE	REQ. CODE

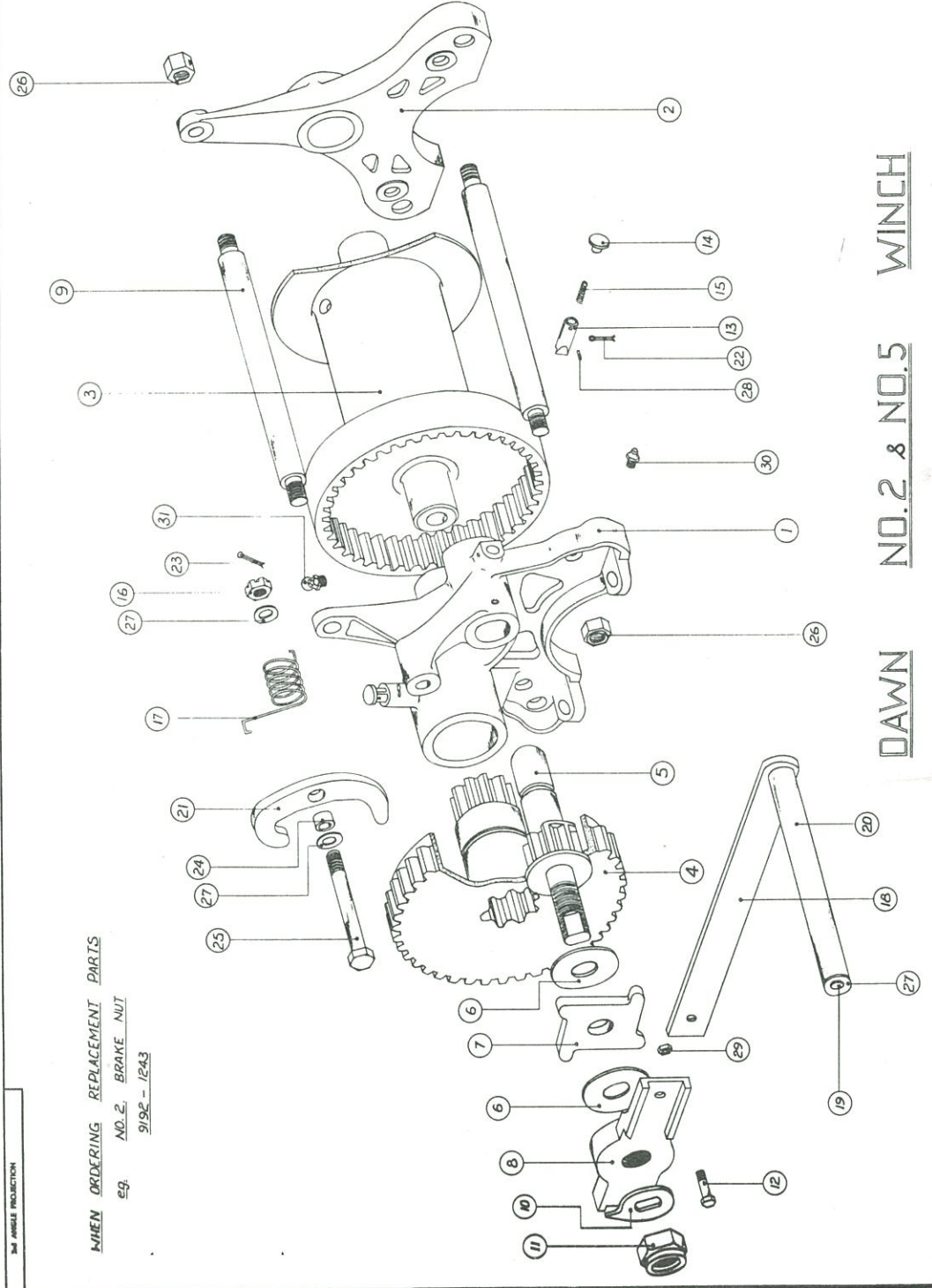

**DAWN NO. 2 & NO. 5 WINCH**

DO NOT SCALE  
Tolerances unless otherwise specified  
in "I" (1:16)

**PARTS**

NO.	ALTERNATION	APP. DATE	IF IN DOUBT — ASK	SCALE

**G. N. RAYMOND LTD.**  
COLLINGWOOD  
APP BY DRAWING NO.

CHKD.  PASSED   
DATE: 10-1-44  
**C. 277.**